

WIRE GUARD FOR LHB LINEAR HIGH BAYS

INSTALLATION INSTRUCTIONS

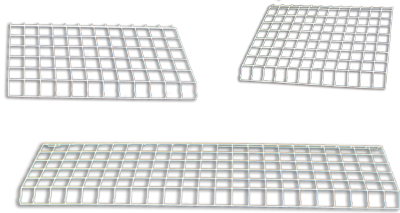

WHAT'S INCLUDED

- WIRE GUARD
- MOUNTING CLIPS X 4
- SCREWS X 4

For use with:

LHB-WG for LHB-904-X / LHB-905-X

LHB-WG135 for LHB-1354-X / LHB-1355-X

LHB-WG174 for LHB-1744-X / LHB-1745-X

LHB-1784-X / LHB-1785-X

LHB-2234-X / LHB-2235-X

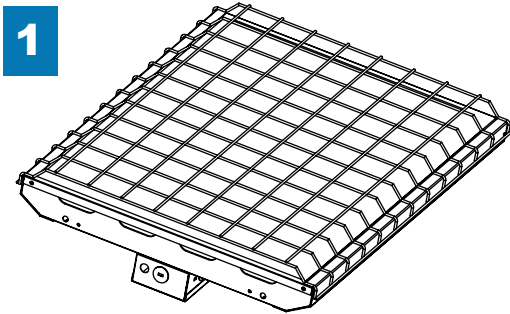

1 Set the Linear High Bay fixture frontside up and place the wire guard on top.

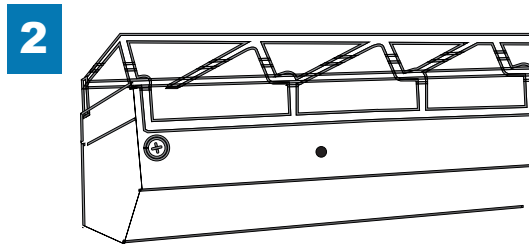

2 Locate the pilot hole that is pre-drilled into the fixture (there is one hole per corner).

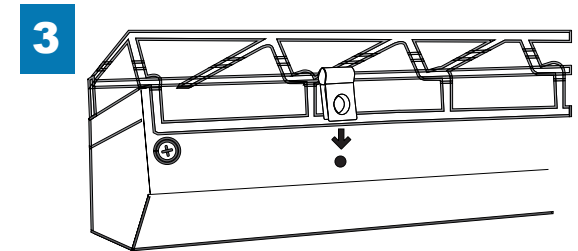

3 Insert the mounting clip onto the wire so that it straddles the wireguard.

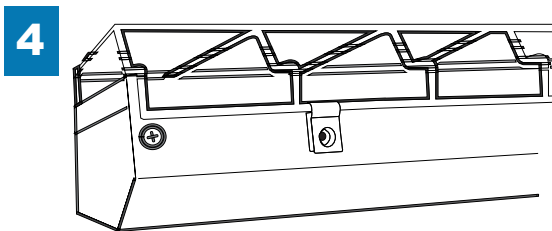

4 With the clip inserted onto the wireguard, line up the clip's hole with the pilot hole located on the fixture.

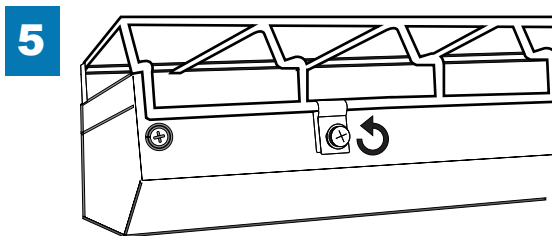

5 Insert the screw through the clip into the pilot hole and tighten. Repeat steps 2-5 for the other three corners of the fixture to complete.